

EXPROOF FLEXIBLE CONDUIT GLANDS

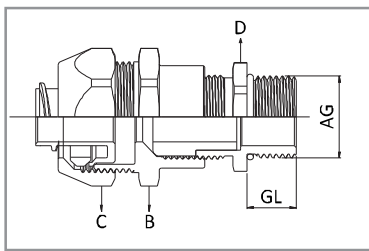

## FLEXIBLE SPIRAL CONDUITS GLANDS

### LIQUID TIGHT WITH CABLE HOLDER

#### TECHNICAL DETAILS

Certificate : IEP 15 ATEX 0355 X  
ATEX, ROHS, CE, PT, TUV  
Protection code : I M2 Ex db I Mb / I M2 Ex eb I Mb II 2G Ex db II C Gb / II 2G Ex eb II Gb II 1D Ex ta II C Da  
Standards : EN 60079-0:2012, 60079-1:2007, 60079-7:2007, 60079-31:2009  
Protection class : IP67  
Temperature range : -20 °C +100 °C  
-30 °C +150 °C

#### Material

Cap nut : Brass with nickel plated  
Clamping insert : PA6 V0  
Sealing ring : TPV  
Ring : PA6 V0  
Ferrule : Aluminium / Galvanised  
Gland body : Brass with nickel plated  
O-ring : NBR / silicone  
Connection thread : Metric EN (60423)/ASME B 10.20.1 / DIN 259

#### Properties

Easy to assemble  
Fixed or swivel body version  
Apply with either LGT or CTS, CTPS type conduits

#### PG FIXED/SWIVEL BODY

Code	AG Thread	Spiral Measure	GL min. mm	B mm	C mm	D mm	Cables mm
ExMLSRP 00	PG 7	10-1/4"	15	20	22	14	3-6,5
ExMLSRP 1A	PG 9	10-1/4"	15	20	22	17	4-8
ExMLSRP 01	PG 11	13-3/8"	15	24	26	20	5-10
ExMLSRP 2A	PG 13,5	16-1/2"	15	27	29	22	6-12
ExMLSRP 02	PG 16	16-1/2"	15	27	29	24	10-14
ExMLSRP 03	PG 21	21-3/4"	15	33	35	30	13-18
ExMLSRP 04	PG 29	26-1"	15	43	45	40	18-25
ExMLSRP 05	PG 36	35-1 1/4"	15	52	54	50	22-32
ExMLSRP 06	PG 42	40-1 1/2"	15	60	63	57	30-38
ExMLSRP 07	PG 48	51-2"	15	74	77	64	34-44

#### METRIC FIXED/SWIVEL BODY

Code	Thread	Spiral Measure	GL min. mm	B mm	C mm	D mm	Cables mm
ExMLSRM 00	M 12 x 1,5	10-1/4"	15	20	22	14	3-6,5
ExMLSRM 1A	M 16 x 1,5	10-1/4"	15	20	22	18	4-8
ExMLSRM 01	M 16 x 1,5	13-3/8"	15	24	26	18	4-8
ExMLSRM 02	M 20 x 1,5	16-1/2"	15	27	29	22	6-12
ExMLSRM 03	M 25 x 1,5	21-3/4"	15	33	35	27	10-14
ExMLSRM 04	M 32 x 1,5	26-1"	15	43	45	34	13-18
ExMLSRM 05	M 40 x 1,5	35-1 1/4"	15	52	54	43	18-25
ExMLSRM 06	M 50 x 1,5	40-1 1/2"	15	60	63	55	22-32
ExMLSRM 07	M 63 x 1,5	51-2"	15	74	77	68	34-44
ExMLSRM 08	M 72 x 1,5	63-2 1/2"	20	90	90	85	45-55
ExMLSRM 09	M 75 x 1,5	78-3"	20	105	110	90	50-63
ExMLSRM 10	M 90 x 2	102-4"	20	136	140	100	60-70

\* NPT thread available on request.

PRODUCT RANGE OVERVIEW

IP 67